

FULLY-SUPPORTED TREAD AND RISERS

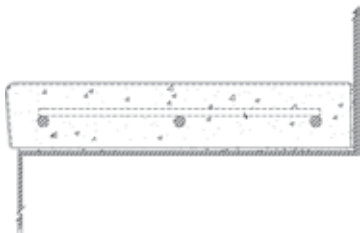

Wausau Tile's fully-supported treads have a 2" minimum thickness and must be fully supported on a full concrete substrate or pan. Treads can be radial or straight and can have tapered ends per your design.

Standard color options include Weatherstone, Light Grind, Ground & Polished and Acid Wash and can be viewed at WausauTile.com.



C30 FLAT TREAD

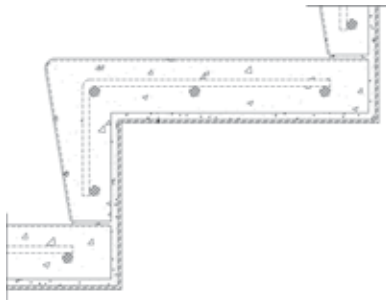

C31 TREAD & RISER

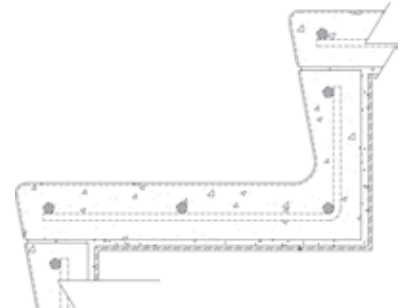

**C36 REVERSE
TREAD & RISER**

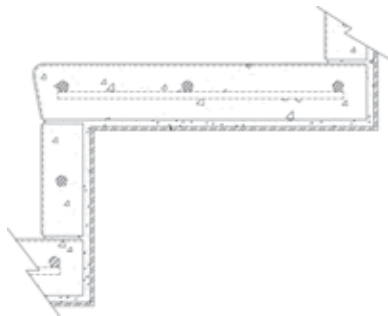

C40 SEPARATE TREAD & RISER



**C51 BLOCK TREAD
(SLANTED NOSE DESIGN)**



**C51 BLOCK TREAD
(SQUARE NOSE DESIGN)**

CALL FOR FURTHER DETAILS & PRICING.



FULLY-SUPPORTED TREAD AND RISERS

PROPERTY	ADVANCED TESTING VALUE	TEST METHOD
Compression Strength	Wausau Tile standard is 5000 PSI at 28 days.	ASTM C39
Water Absorption	Wausau Tile standard is less than 6%.	ASTM C642
Flexural Strength	Non-Standard	ASTM C78 (3rd party test: American Engineering)
C373 Water Absorption	Not-Applicable	
C482 Bond Strength	Not-Applicable	
C485 Warpage Edge	Tolerance of +/- 1/8"	100% Visual inspection of product, Straight edge confirmation as needed.
C485 Warpage Diagonal	Tolerance of +/- 1/8"	100% Visual inspection of product, Straight edge confirmation as needed.
C499 Nominal Size	Tolerance of +/- 1/8"	100% Inspection, Measurements verified against fabrication drawings.
C499 Thickness	Tolerance of +/- 1/8"	100% Inspection, Measurements verified against fabrication drawings.
Dynamic DCOF	Non-Standard, As specified for walking surfaces only.	ANSI 326.32017 (3RD PARTY: TCNA)
ANSI A173.1 Section 9.6.1	Not-Applicable (Tile only)	
Avg. Polished Finish	100% Visual Inspection	Visually compare product to control sample
Avg. Honed Finish	100% Visual Inspection	Visually compare product to control sample
Freeze/Thaw	Non-Standard	ASTM C666 (3rd Party, American Engineering)
Center Load	Not-Applicable (Pavers only)	

CALL FOR FURTHER DETAILS & PRICING.

P: 800.388.8728 | E: wtile@wausautile.com | WAUSAUTILE.COM

10.19.20