



WAUSAU TILE

TERRA SYSTEM ONE

PRODUCT ADVANTAGES

- Increase design capabilities on roof decks or pitched surfaces
- Multiple paver applications possible
- One system with interchangeable parts
- Allows for easy installation of Wausau Tile architectural pavers





TERRA SYSTEM ONE

The Terra System One pedestal system helps navigate the challenges of a pitched surface with ease, designed for roof deck applications as well as roof plazas, parking garages, roof terraces and more.

This system provides a level surface for installation of concrete pavers over a pitched surface from $\frac{1}{8}$ " to $21 \frac{1}{2}$ ". It also ensures precise paver alignment with even spacing to allow drainage and air circulation critical to the health of a deck installed over any waterproof membrane. It allows for easier access to the subsurface for scheduled maintenance or repairs without damage to the paved surface.

Terra System One consists of several accessories that are used with multiple Wausau Tile products. Highlighted within this section are the required and optional accessories that help create the perfect roof deck space.

Pavers installed using a pedestal system are designed for pedestrian traffic only.

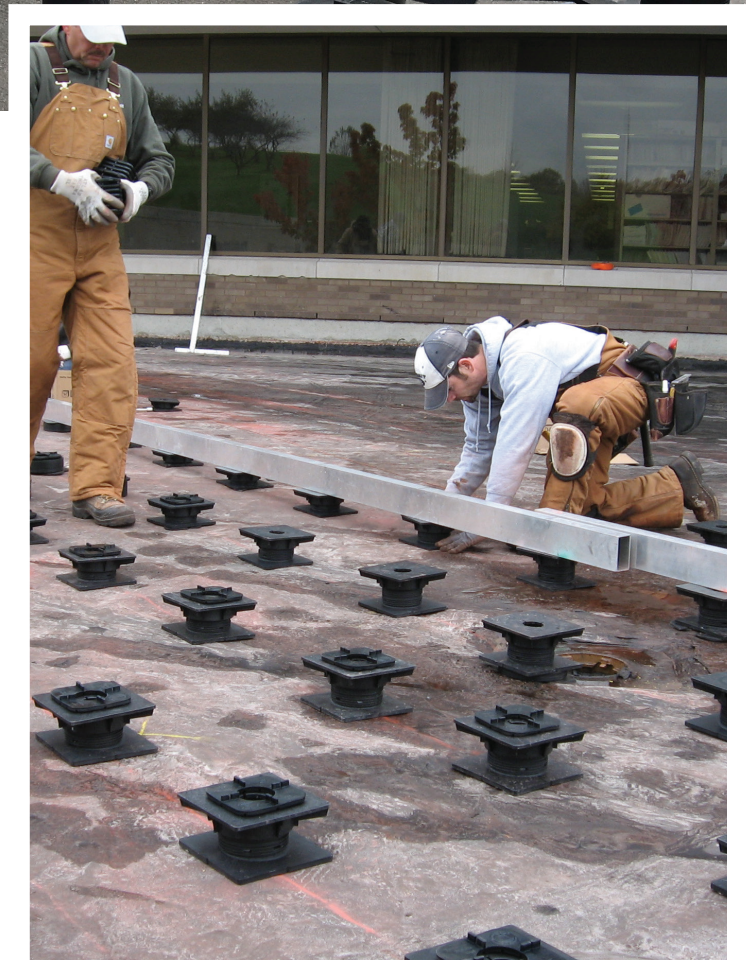

TERRA SYSTEM ONE IS USED WITH:

- Hidden Lok-Down
- IPE Pavers
- Lok-Down System for Wind Uplift
- Roof Deck Pedestal System
- Terra-Grid

HIDDEN LOK-DOWN SYSTEM

Required Products:

- Hidden Lok-Down Unit
- Terra-Tab
- Use of either Terra-Stand or Waffle Reducer Hidden Lok-Down Plate

Optional Products:

- Terra-Shim Plates

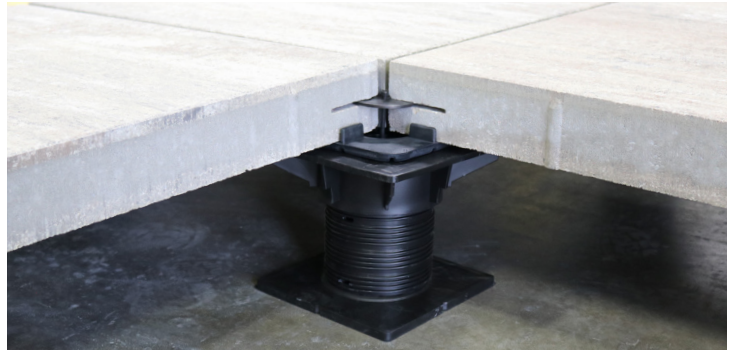

IPE PAVERS

Optional Products:

- #6 IPE Tab
- Rubber Spacers
- Terra-Pad
- Terra-Shim Plates
- Terra-Stand
- Terra-Tab
- Waffle Reducer



LOK-DOWN SYSTEM

Required Products:

- Lok-Down
- Terra-Tab
- Use of either Terra-Stand or Waffle Reducer

Optional Products:

- Rubber Spacers
- Terra-Pad
- Terra-Shim Plates



ROOF DECK PEDESTAL SYSTEM

Optional Products:

- Lok-Down
- Rubber Spacers
- Terra-Pad
- Terra-Shim Plates
- Terra-Stand
- Terra-Tab
- Waffle Reducer



TERRA-GRID SYSTEM

Required Products:

- Terra-Grid
- Terra-Grid Cube Unit
- Terra-Stand

Optional Products:

- Rubber Spacers
- Terra-Pad
- Terra-Shim Plates
- Terra-Tab
- Waffle Reducer

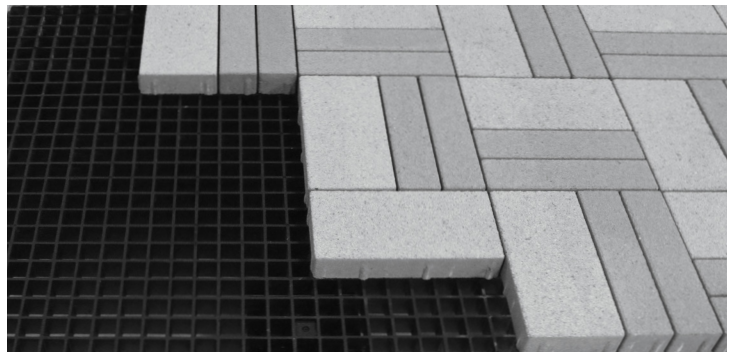

HIDDEN LOK-DOWN UNIT

Hidden Lok-Down Unit allows the pavers to be mechanically fastened into the pedestal and surrounding pavers, reducing the visibility of the system and creating a more aesthetic paver installation.

Hidden Lok-Down Unit includes a stainless steel washer and bolt with a plastic puck.

- Washer size is 2.5" dia.
- Tighten bolts to two foot pounds of torque using a torque wrench

Required for:

- Hidden Lok-Down System



#6 IPE TAB

Used exclusively with our IPE pavers, the #6 IPE Tab helps secure pavers in place. Made from rubber with plastic inserts, this tab helps reduce the sound of pavers on the pedestal.



LOK-DOWN

Our Lok-Down mechanism is designed to help create a safe roof top space in areas where high-wind conditions exist. With the use of architectural pavers, the mechanism locks the pavers together to create a rafting effect. The Lok-Down is made from plastic and can be used in conjunction with our Terra-Stand pedestal or Waffle Reducer. Several colors are available to help match the Lok-Down to pavers.

See pg. 61 for Lok-Down cap colors.

Required for:

- Lok-Down System



RUBBER SPACERS

Create a $1/8$ ", $3/16$ " or $1/4$ " space between pavers with the use of Rubber Spacers. When combined with our Terra-Shim Plates, irregularities in deck sub-surfaces are reduced.

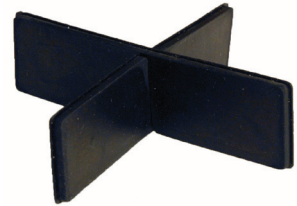

TERRA-GRID

Wausau Tile's Terra-Grid is a lightweight, fiberglass and fire resistant option that brings durability and strength to your roof top space. Designed specifically to work with our Terra System One pedestal system, a level surface is created to help navigate pitched surfaces for easy installation. With the capability to use even the smallest of our pavers, our Terra-Grid helps bring endless creative options to your project without the increased use of pedestals or timely labor. Built to hold more than 550 lbs. per sq. ft., our Terra-Grid does not require the use of weights to create safe and enjoyable outdoor environment.

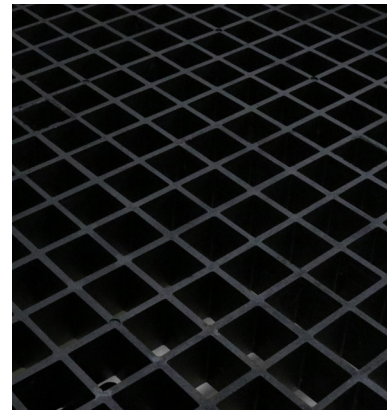

Required for:

- Terra-Grid System

TERRA-GRID CUBE UNIT

Our Terra-Grid Cube Unit is used to lock a Terra-Grid securely to a Terra-Stand without the use of weights. Once a level surface is created, architectural pavers of any size and configuration can safely be placed on the Terra-Grid. Made of a Grivory-GV6H glass filled nylon material and measuring 1.16" x 1.3" x 1.125", our Terra-Grid Cube is specifically designed to work with our Roof Deck Pedestal System.

The Terra-Grid Cube Unit includes Terra-Grid Cube, metal bolt and plastic puck.

Required for:

- Terra-Grid System



TERRA-PAD

Our Terra-Pad is an 8" x 8" x 1/8" rubber protection pad which can be used under the Terra-Stand and Waffle Reducer to protect your waterproof membrane.



TERRA-SHIM PLATES

Manufactured to coincide with our Terra-Tab, the Terra-Shim Plates are made of rubber and help reduce the irregularities in deck sub-surfaces. Terra-Tabs and Terra-Shims can be set directly on the waterproof membrane, on an optional protection pad or insulation without harm.

#5 - 1/16" thick, 5" sq.

#5 - 1/8" thick, 5" sq.

#5 - 1/4" thick, 5" sq.



TERRA-STAND

Adjustable pedestal that screws up, down and tilts from side to side to provide a level surface for the paver installation.

Terra-Stand Pedestals are made of a high impact copolymer polypropylene that adjust from 3" to 21 1/2" in height, with slope compensating up to 5/8" to provide a level installation.

Outside base dimension of 7" x 7" provides contact surface of 49" square. It is installed on previously established grid lines, adjusted for height and slope and ready for installation. Average compressive strength of 3,000 pounds per pedestal.

Required for:
· Terra-Grid System



TERRA-TAB

Terra-Tabs allow for perfect spacing between paver joints and allow for expansion, air circulation, drainage and precise paver alignment. Terra-Tabs are made out of rubber and used in conjunction with Terra-Stand pedestals and Waffle Reducers. It can be used by itself when no elevation or leveling is needed. Available in the following sizes:

#5 - $\frac{3}{8}$ " thick, 5" sq, $\frac{3}{16}$ " wide spacer

#5a - $\frac{3}{8}$ " thick, 5" sq, $\frac{1}{8}$ " wide spacer

Required for:

- Hidden Lok-Down System
- Lok-Down System



WAFFLE REDUCER HIDDEN LOK-DOWN PLATE

The Waffle Reducer for Hidden Lok-Down comes $\frac{3}{4}$ " thick and with the bolt and washer needed for the Hidden Lok-Down System. It's designed to be used by itself or can be placed on top of our Waffle Reducer, both methods are used to secure our architectural pavers. The use of a #5 Terra Tab is required with this item to install our pavers.

This item is sold separately from our Waffle Reducer.

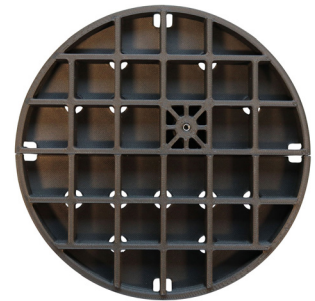

WAFFLE REDUCER

Waffle Reducers are manufactured to accommodate height adjustments of $\frac{1}{2}$ " to 3". With a Terra-Tab placed on top, the unit consists of one base with 3 pieces of $\frac{3}{8}$ " waffle rings and 2 pieces of $\frac{3}{4}$ " waffle rings. An outside base diameter of 6" provides surface contact of 28 square inches. The waffle reducer is made of high impact copolymer polypropylene.

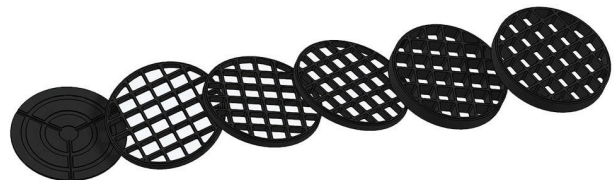



ARCHITECTURAL PAVER ACCESSORIES

BLOK HANDLE

Made of 10-gauge HRCQ steel, Blok Handles are available for 12", 18" and 24" Terra-Pavers. Precise sizing of the handle provides for easy manipulation during installation without harm to the paver or other components, while allowing for $\frac{3}{16}$ " (4.76 mm) joints. The handle also makes removal easy should repairs to subsurface components be necessary.

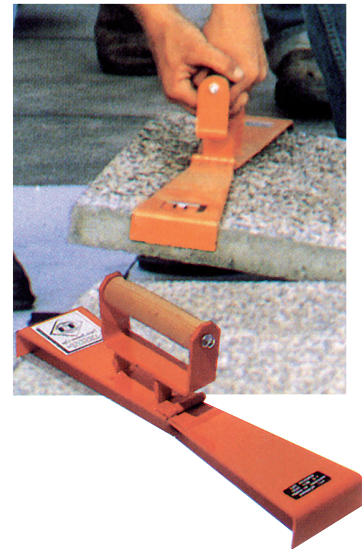

BIG-BLOK HANDLE

Made of steel, unit is adjustable to work with 24", 30" and 36" pavers. Requires two people to operate.

Optional wheel attachment that allows for a one man operation is available.





TERRA-STAND PEDESTAL SYSTEM INSTALLATION

Pavers can be Install on top of pedestals 2 different ways:

- 1 - Installation can start at the center of pedestal grid, and work toward the edges. Edge pavers will need to be cut to fit.
- 2 - Installation can start at a wall with full size pavers. As grid is filled, edge pavers will need to be cut.

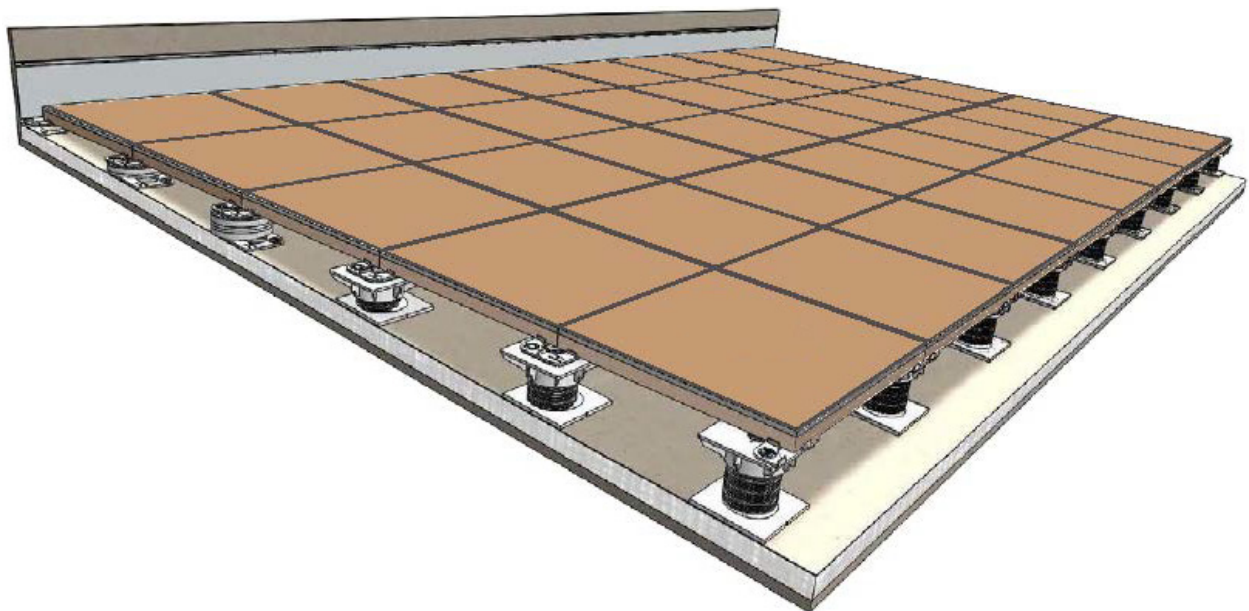

A	B	C	D	E
Waffle Reducer	6" Terra Stand	11" Terra Stand	16" Terra Stand	21" Terra Stand
Adjusts 1/2" - 3"	Adjusts 3" - 6.5"	Adjusts 3.5" - 11.5"	Adjusts 6" - 16.5"	Adjusts 11" - 21.5"



A



B



C



D

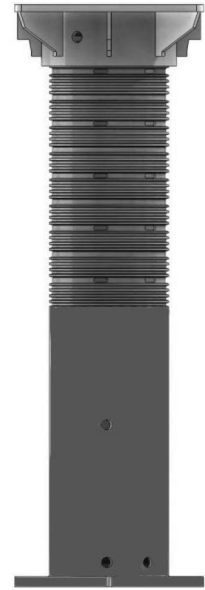

E

- Determine paver height.
- Establish paver grid lines. Grid can be centered in the area or aligned with a wall.
- Set quadrant pedestals at required height.
- Use a transit or laser level to determine pedestals height.

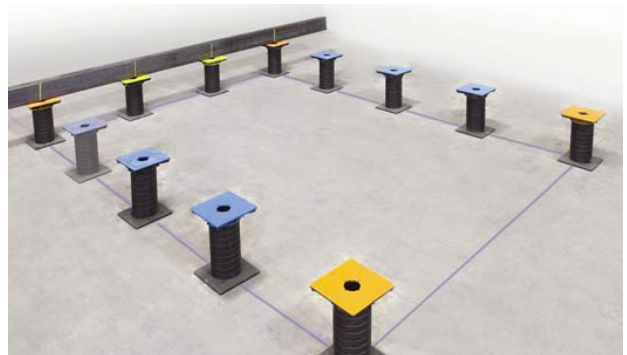
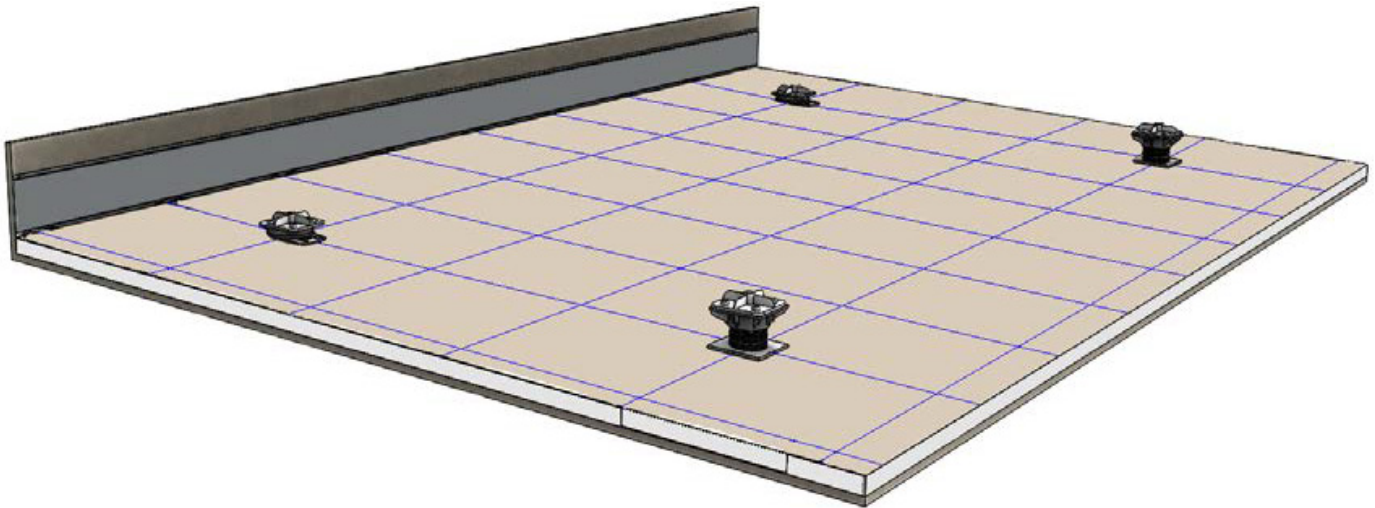

- With base flat on sloped roof, level pedestal top and tighten base nut.
- Pedestal core must be visible through side inspection hole.
- Make final height adjustments by rotating top of pedestal.
- Pedestal cores are cut to length, discarding open end piece.

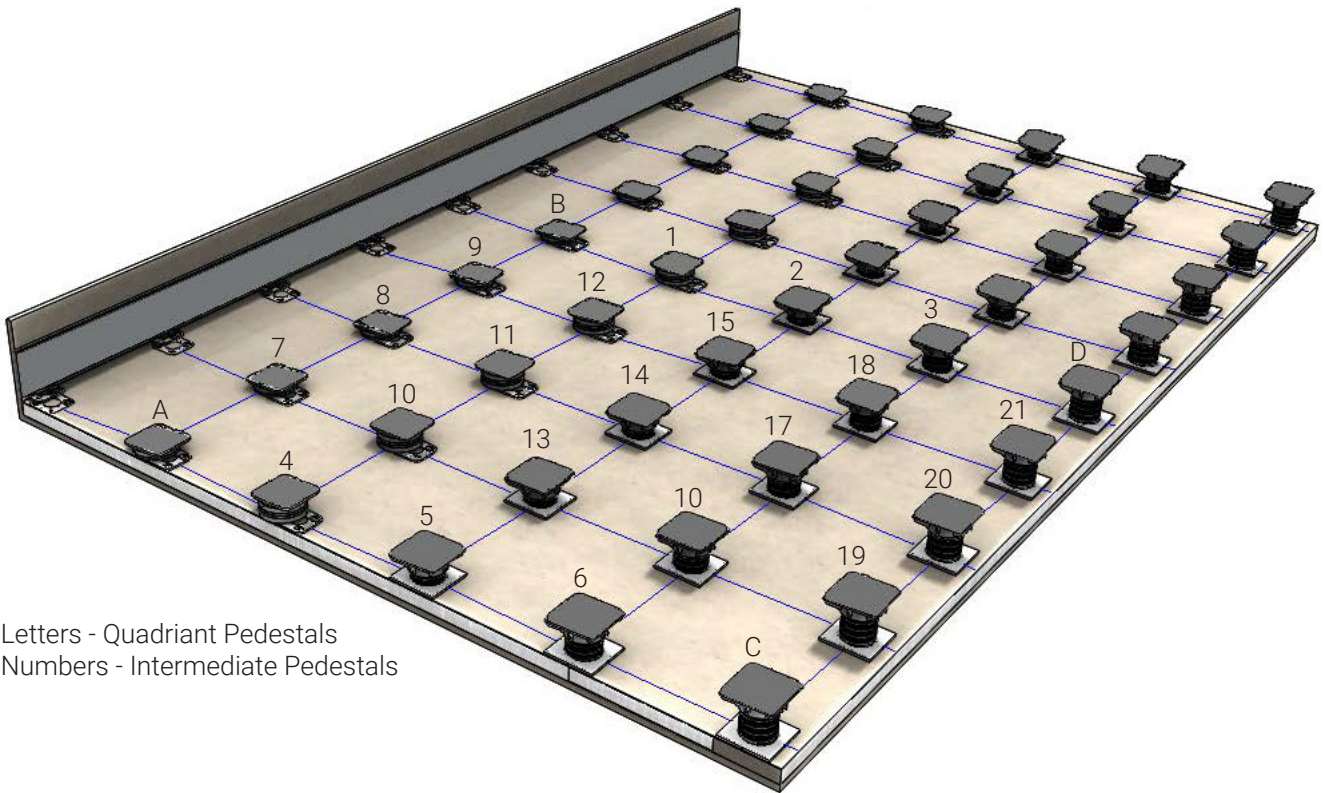
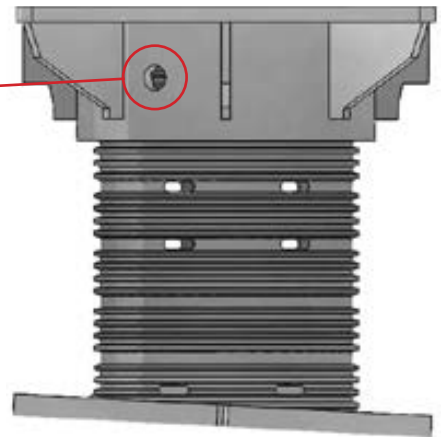

Letters - Quadriant Pedestals
Numbers - Intermediate Pedestals

- Position intermediate pedestals at the grid intersection lines between quadriant pedestals.
- Use a straight edge to set intermediate pedestals to desired height. Screw to bottom of Bar & Lock.
- Terra Tabs provide spacing between pavers. They are placed on top of the Waffle Reducers and Terra Stand Pedestals.



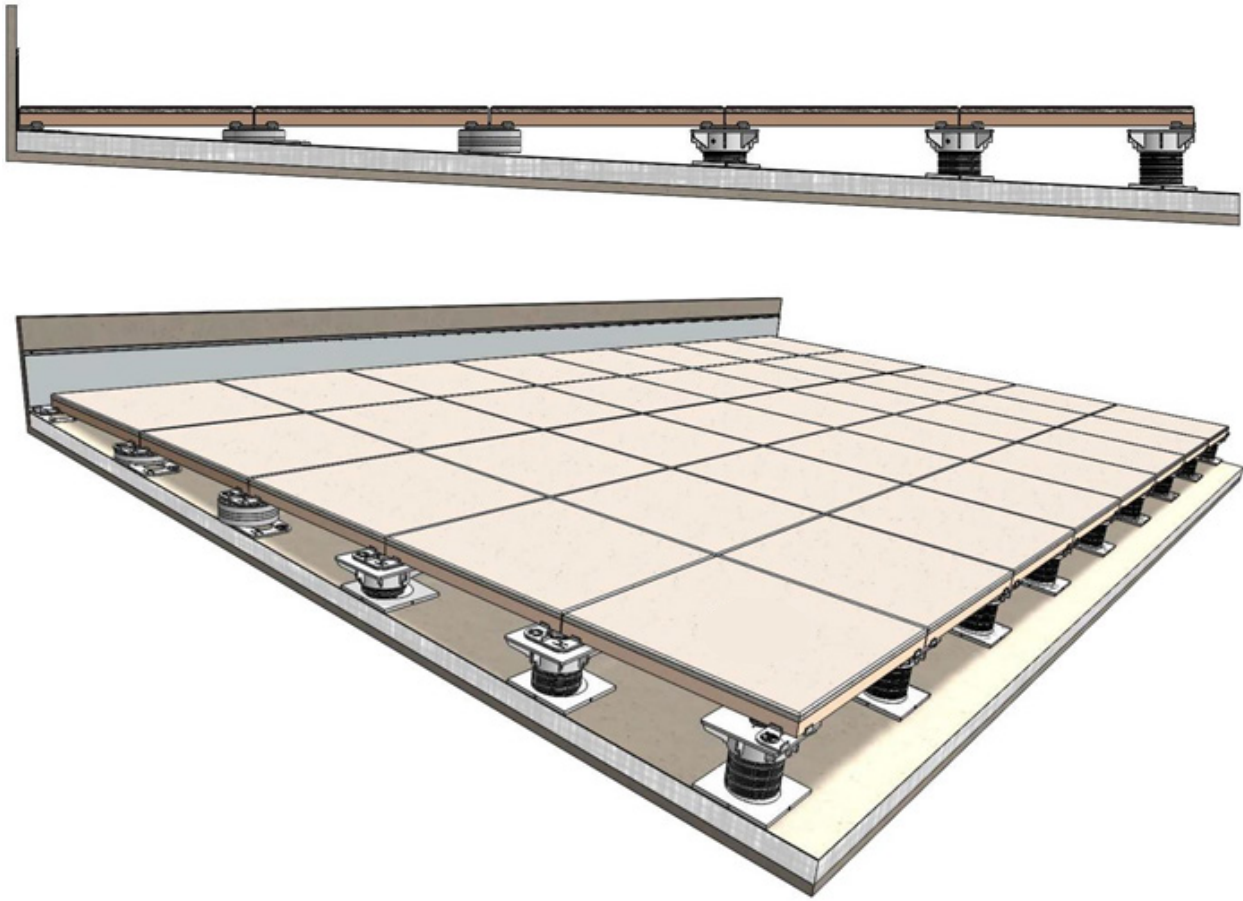

WALL / BUILDING TERMINATION USING TERRA-TAB

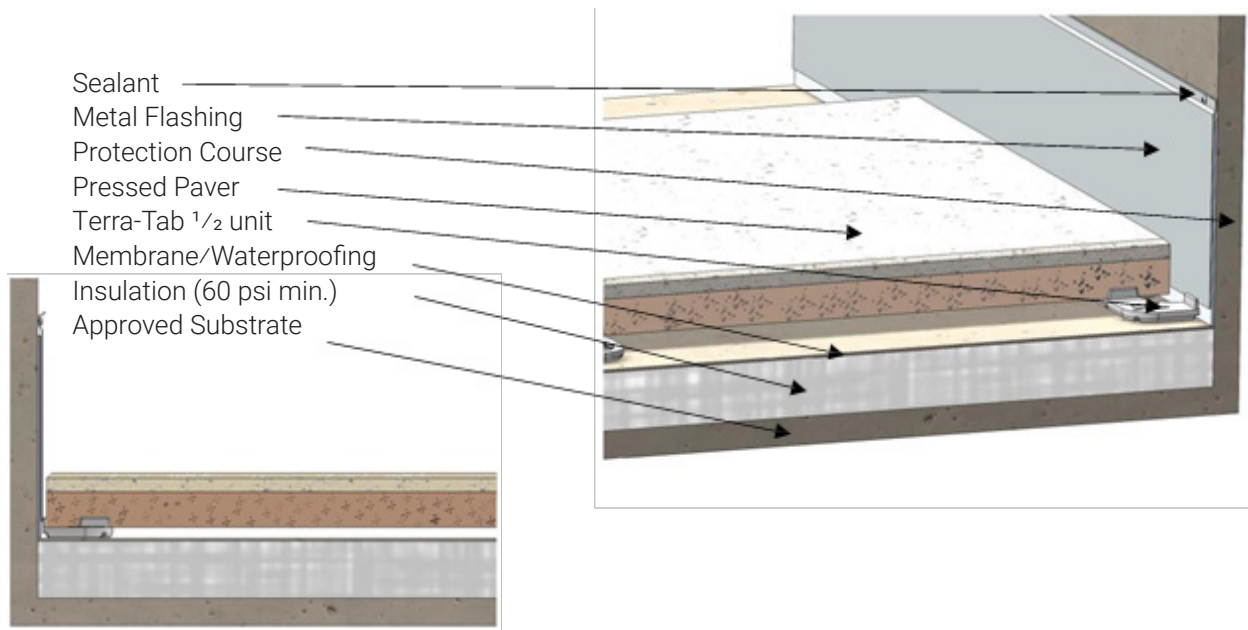

WALL / BUILDING TERMINATION USING WAFFLE REDUCER

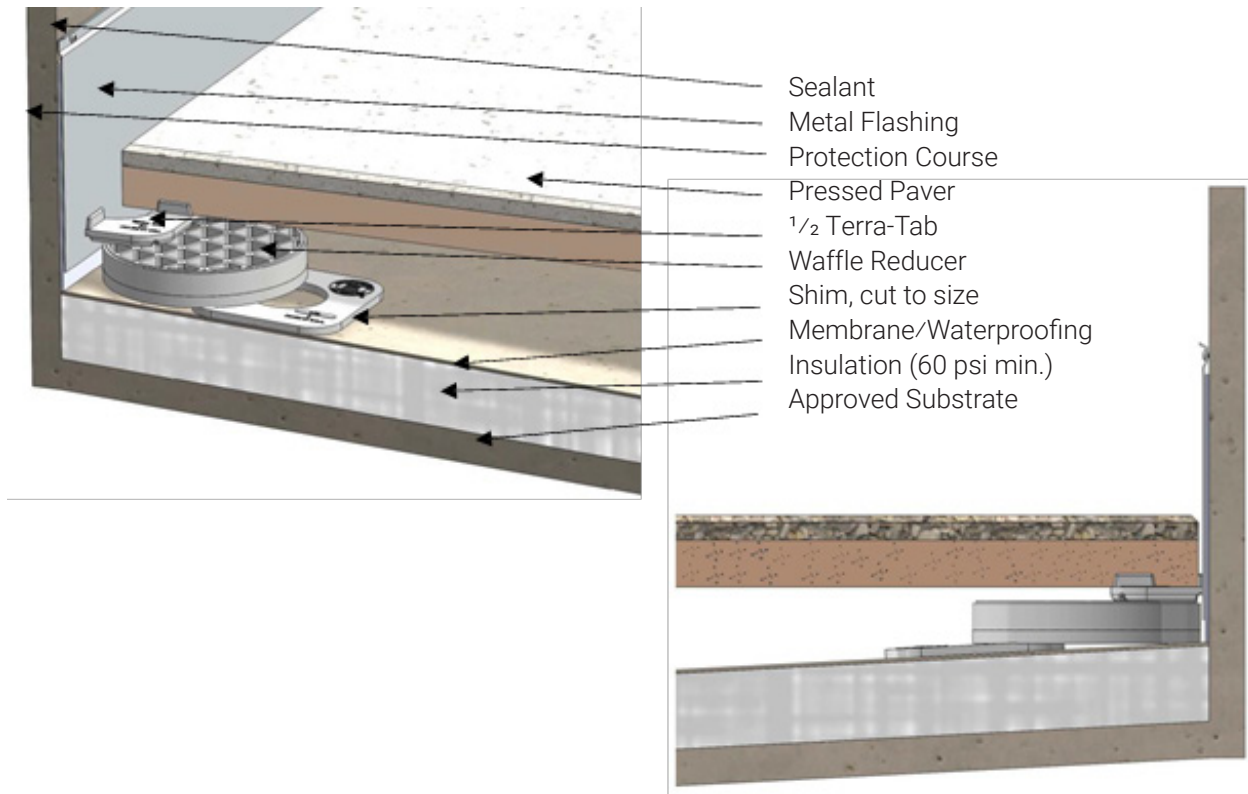

WALL / BUILDING TERMINATION USING TERRA-STAND

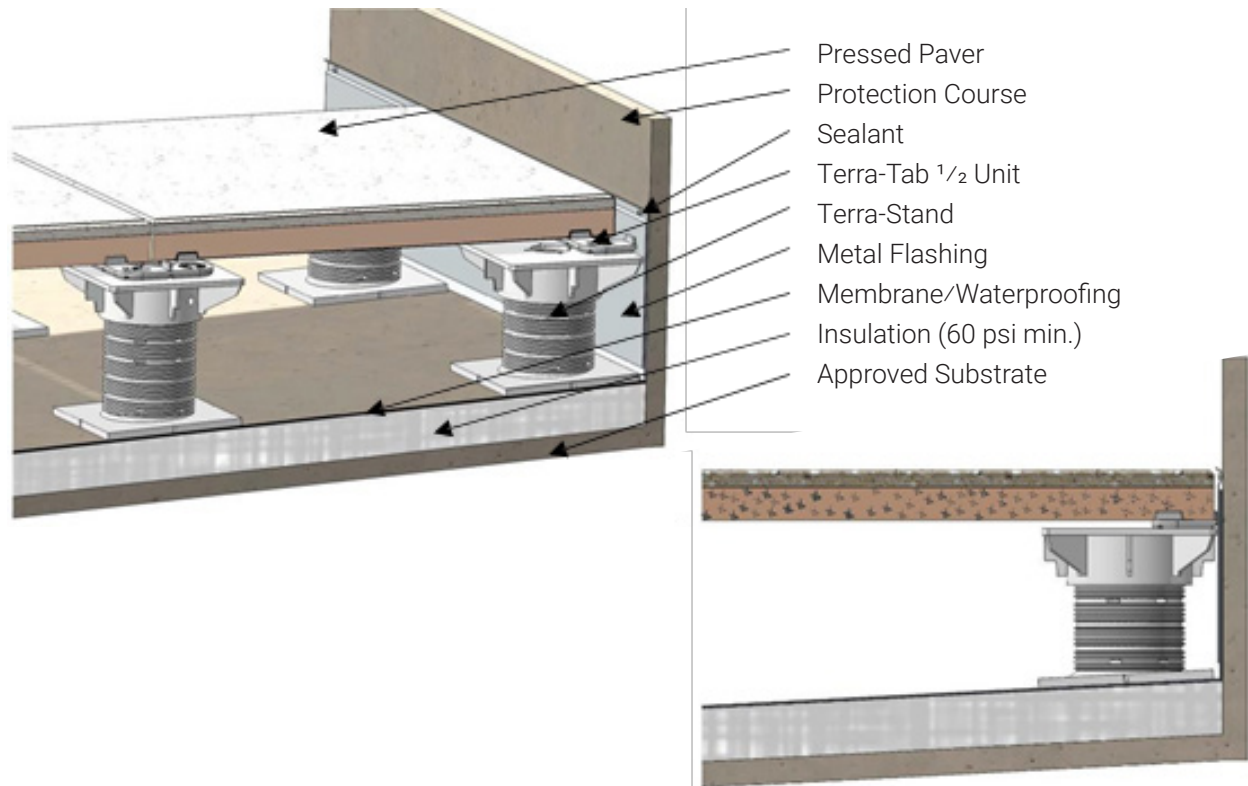

PAVER JOINT

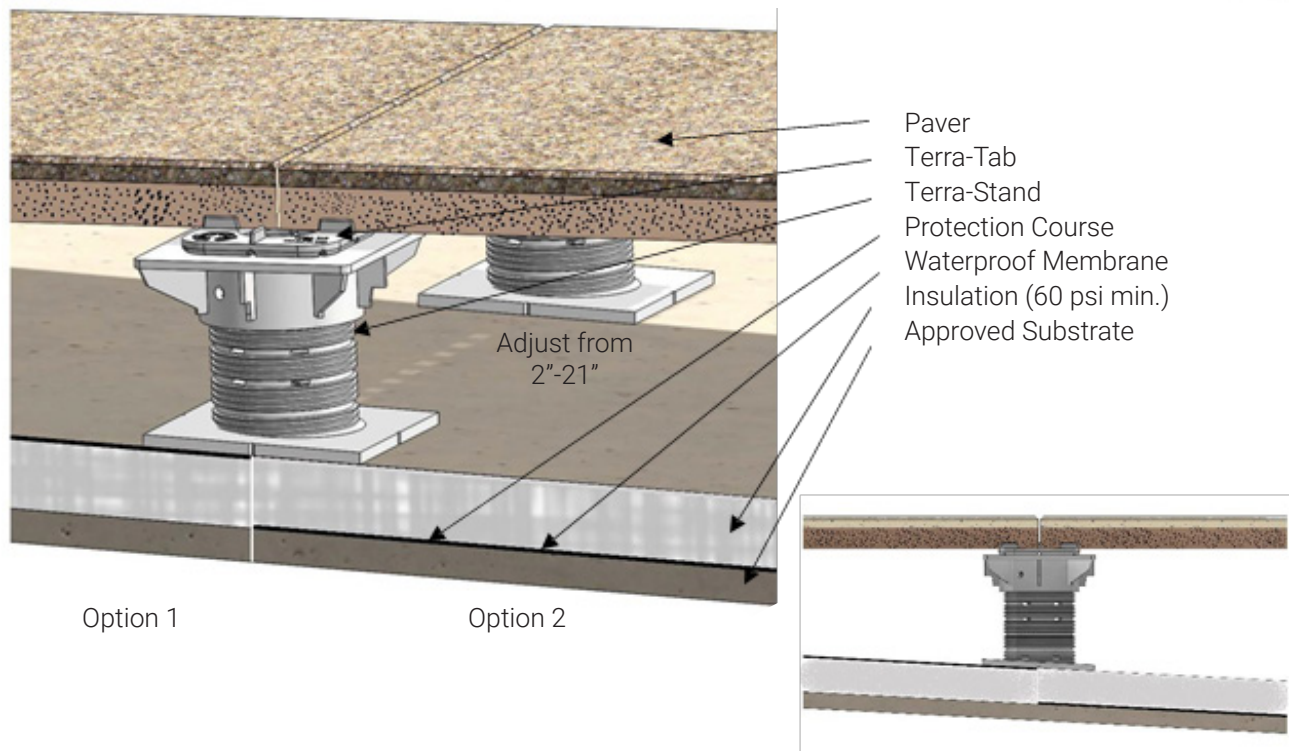
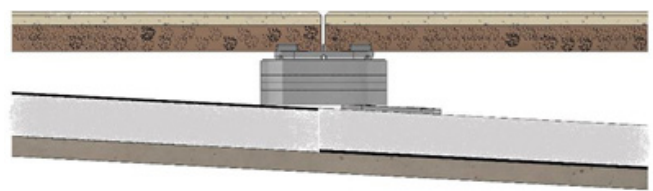
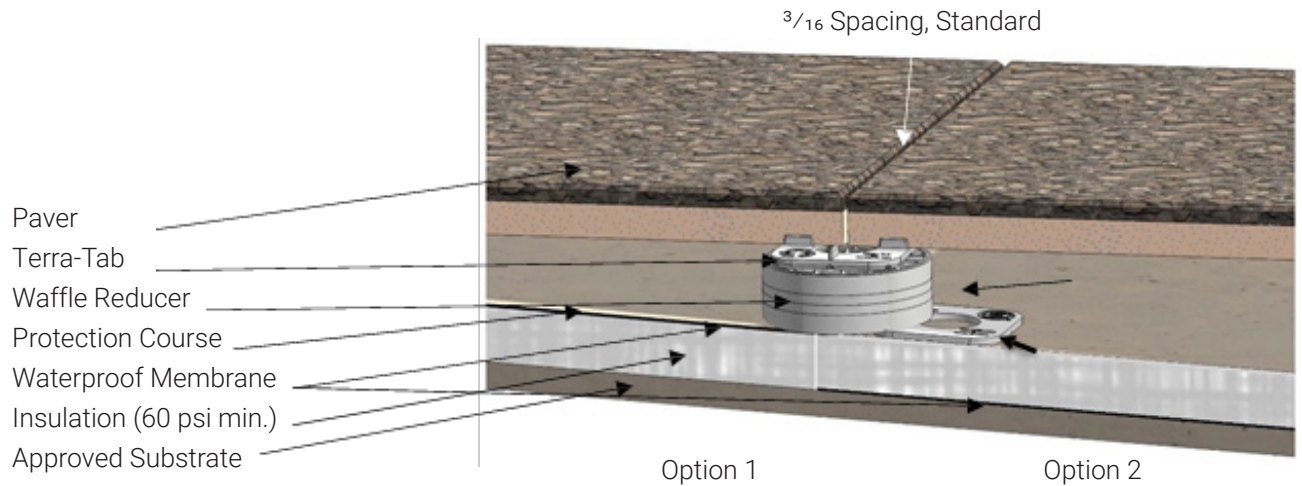
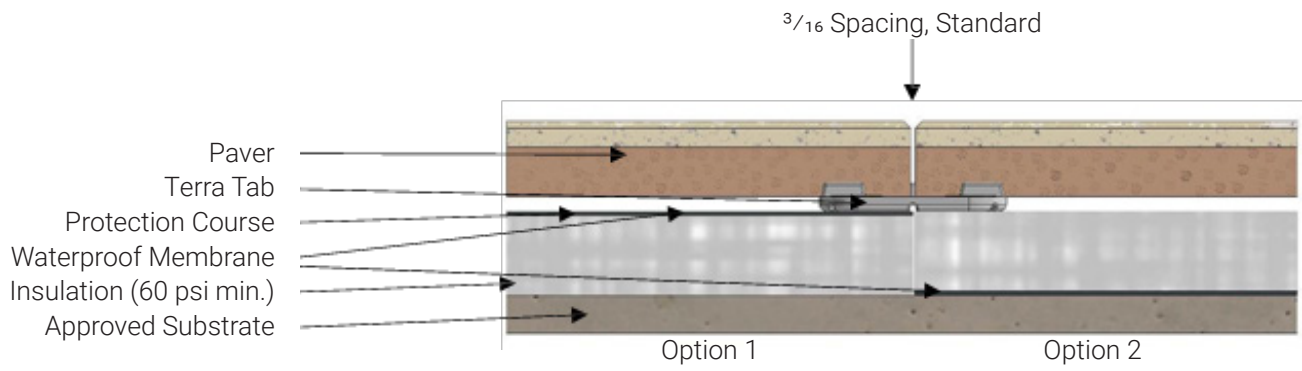



Maintaining Wausau Pavers

Wausau Tile pavers can be maintained to retain the attractive appearance and prolong the life of the pavers. When using maintenance materials, please follow the product manufacturer's instructions regarding the use of any equipment or cleaning materials described here. Be sure to angle the spray and limit the pressure to 2,000 PSI, as not to damage the surface of the paver when using a pressure washer. For specific or unusual problems, please call us at 800-388-8728

Weekly Maintenance:

Sweep or pressure wash deck. In areas of high traffic, such as doorways, daily cleaning may be required.

Semiannual Maintenance (Spring and Fall):

Power sweep, then pressure wash total deck surface. Spot clean any stained areas using procedures described in "Cleaning Heavily Soiled Areas."

Remove pavers located over drains on open joint systems. Clean Debris from all drain covers to prevent plugging of drains and replace pavers.

Check pavers for rocking, low or high edges, joint spacing, alignment and broken or chipped pavers. If minor settling or movement has occurred, pavers can be leveled and adjusted with shims. Chipped or broken pavers should be replaced

Cleaning Heavily Soiled Areas:

Soiled areas should be cleaned as soon as possible to avoid staining. The type of material causing the soiling determines the correct procedures.

A. Oil or Petroleum Products

Remove as much of the material as possible with hot water high pressure washer. Apply degreaser cleaner directly to the soiled area. With a stiff nylon brush or broom, scrub the area. Rinse the area with hot water high pressure washer. In some cases, a second cleaning may be required.

B. Rust Stains

Soak area with water. Scrub rust stains with masonry cleaner products per manufacturer's recommendations. (Be extremely careful around any metal surfaces). Rinse area thoroughly.

C. Soiling from Normal Foot Traffic, Road Salts, Everyday Use

Wash area thoroughly with hot water high pressure washer. On heavily soiled areas, spray the area with a commercial grade cleaner and scrub with a nylon brush. Rinse thoroughly.

D. Gum or Tar

Apply dry ice directly on top of the gum or tar. After freezing, use a putty knife or scraper to remove the gum or tar from the surface.

E. Tobacco Stains on Light Colored Pavers

After pressure washing with hot water, saturate a paper towel with household bleach. Apply towel directly to stain and cover with minimum 3 mil poly. Tape poly to surface to hold in place. Leave stain covered for 24 to 48 hours.

Remove to see if stain is gone or lightened. Repeat if necessary.

Cleaner Recommendations (Follow all manufacturer instructions):

- Techniseal - Paver Prep (HD) Heavy Duty Efflorescence Cleaner
- Prosoco - Sure Klean 600 (New Masonry Cleaner)
- Rain Guard Restore-N-Prep



Snow Removal:

Snow can be cleaned from the deck using shovels, walk-behind snow blowers or power brushes. A four wheeled garden tractor, weight not exceeding 1,700 lbs. manned, can also be used. Nylon or rubber scrapers are recommended to avoid scratching of pavers. Tire chains can cause minor scratching and extra care should be taken with chains.

The use of snow melt materials should be minimal and in accordance with manufacturer's recommendations. Some types of snow melt are not recommended for use on new concrete and can cause surface damage to the paver.

De-Icer Recommendations (Follow all manufacturer instructions):

- Melt-Off - Ice Melter
- Premier - Ice Melter
- Road Runner - Ice Melt

Open Joint Installations:

Open joint installation is unique in that the pavers are elevated to allow water and air to flow through the joints of the pavers. It is essential that all the joints and all drains stay open, clean and free of dirt and debris. Failure to maintain clean joints may result in performance issues.

Efflorescence in Colored Pavers:

Efflorescence is a condition which appears as a white stain on some colored concrete and masonry products. It is a common occurrence in new concrete, created by sodium and sulfate compounds of several hydroxides, minerals, chlorides and nitrates which deposit on the surface and pores. It is the result of moisture evaporation and is most common on darker colored pavers and fabricated surfaces.

Water (rain, humidity, or ground water which "wicks") penetrates the pavers and dissolves latent salt. Sun draws the salt in solution to the surface and as moisture evaporates it is deposited on the surface. Efflorescence clears up as paver's age and eventually dissipates. The length of time varies with weather conditions and wear. Efflorescence can also be caused when salts in the sub-base material wick up around and through the pavers and joints and deposit on the paver surface and sides.

Efflorescence Cleaner Recommendations (Follow all manufacturer instructions):

- Techniseal - Paver Prep (HD) Heavy Duty Efflorescence Cleaner
- Quickrete - Efflorescence & Rust Remover
- Techniseal - Paver Prep & Efflo Cleaner

Wausau Tile Warranty:

Wausau Tile products are warranted to be free from defect in material and workmanship during manufacturing based on applicable industry standards. Warranty periods begin on delivery date of the warranted product and extend for the period listed below:

- Precast terrazzo products are warranted for two years.
- Terrazzo tile, plastic and metal pieces are warranted for one year.
- Framing and aluminum products are warranted for two years.
- Powder coating is warranted for two years.
- Thermo-plastic coating is warranted for five years.
- Concrete site furnishings are warranted for two years.
- Pavers are warranted for three years if properly installed according to both project specifications and Wausau Tile installation recommendations. Placing pavers on non-Wausau Tile pedestals voids this LIMITED WARRANTY.